



Southern Accents Venue

A historic chapel, event pavilion, and lodging for your next occasion.



Packet Contents

Venue Diagram _____	Pg. 1
Wedding Rental _____	Pg. 2
Event Rental _____	Pg. 3
Lodging Rental _____	Pg. 4
Rental Policies _____	Pg. 5-7
Preferred Vendors _____	Pg. 8

View a gallery of photos from Southern Accents Venue on our Facebook page, @SouthernAccentsVenue

Southern Accents Venue

7 Woodruff 654
McCrary, AR 72101

SouthernAccentsVenue.com
SouthernAccentsVenue@gmail.com

Questions? Please review this packet in detail,
then contact Joe Williams at 870-919-0617.

Southern Accents Venue

Chapel Suites in
Upper Level
Sleeps 12

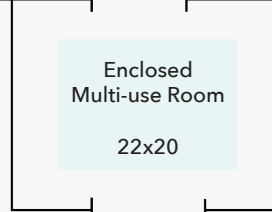
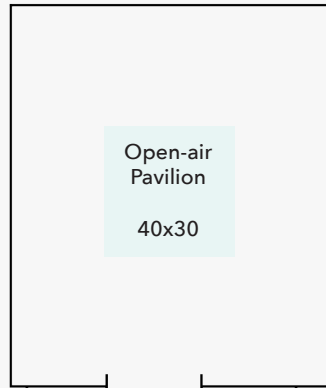
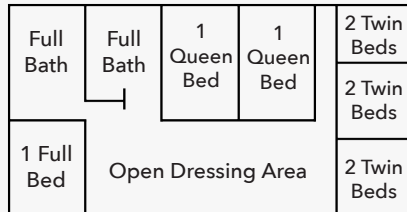

Lodge House
Sleeps 8

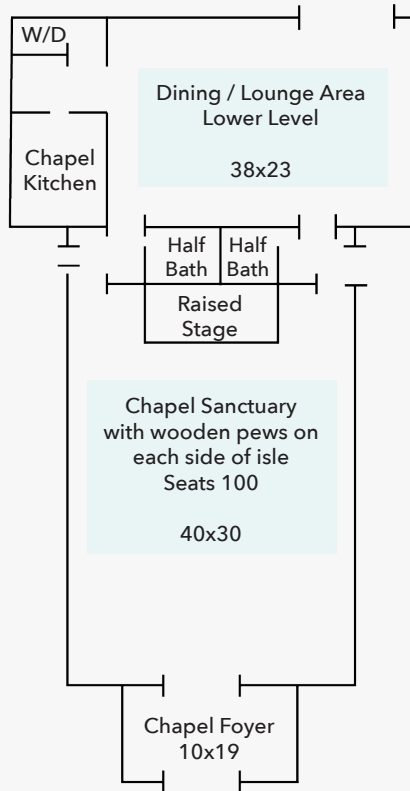
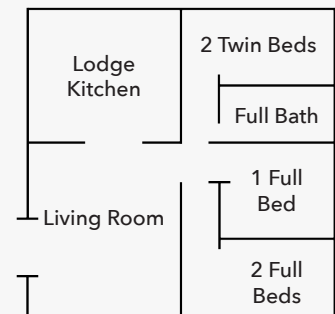

Gravel Area
Between Buildings

Weddings at Southern Accents Venue

For five guests or over 100, Southern Accents Venue provides a unique backdrop for your wedding with timeless touches and modern flair. From an open-air pavilion with rustic, intricate beam ceiling and sliding barn door, to the historic chapel with original, mid-1900s wood flooring and pews, you're sure to find the perfect combination of spaces for your special day.

Weddings at Southern Accents Venue Include

- Historic mid-1900s chapel with raised stage, chandelier lighting, and original wood flooring and pews (seats 100)
- Open-air Pavilion with intricate beam ceiling and adjoining Enclosed Multi-use Room
- Dining/Lounge Area adjoining the Chapel
- Bridal open dressing area in upper level of Chapel Suites, and Groom dressing area in Lodge House which includes the living room and full bathroom
- Two Kitchens: The Chapel Kitchen is adjoined to the Chapel and Dining/Lounge Area and is equipped with sink, stove, double oven, refrigerator, and counter-top prep area. The Lodge House Kitchen is conveniently situated next to the Pavilion and is equipped with refrigerator, stove/oven combo, microwave, and coffee pot.
- Guest access to two half baths conveniently located between the Pavilion and Chapel
- Access to grounds for photography, including a nearby pond, green spaces, wooded areas, and sunflower fields when in season

Other

Lodging options can be found on page 4.

Add-on event rental items available.

See recommended catering, floral, and event coordinators on page 8.

Rates

Monday–Thursday, 8 a.m.–Midnight	\$600.00
Friday, 8 a.m.–Midnight	\$800.00
Saturday, 8 a.m.–Midnight	\$1,200.00
Sunday, 8 a.m.–Midnight	\$800.00

Please review important Event Rental Policies on pages 5, 6, & 7.

Daily Event Rental at Southern Accents Venue

Southern Accents open-air pavilion and enclosed multi-use room provide the perfect space for your gathering. Guests will be charmed by the rustic, intricate beam ceiling of the pavilion and sliding barn door leading to the multi-use room. Whether you are hosting a small family gathering, or a large community event, the fully equipped kitchen makes catering a breeze.

Daily Event Rental at Southern Accents Venue Includes

- Open-air Pavilion with intricate beam ceiling and adjoining Enclosed Multi-use Room
- Chapel Suite Kitchen, equipped with sink, stove, double oven, refrigerator, and counter-top prep area
- Dining/Lounge Area adjoining the Chapel Kitchen
- Guest access to two half baths conveniently located between the Pavilion and Chapel

Rate

Daily Event Reservations may not be made more than two months before the event date.

Hourly Rate of \$100.00/Hour with a Minimum of 4 Hours.

Setup and cleanup time is charged at the same hourly rate.

Other

Lodging options can be found on page 4.

Add-on event rental items available.

See recommended catering, floral, and event coordinators on page 8.

Please review important Event Rental Policies on pages 5, 6, & 7.

Lodging Rental at Southern Accents Venue

Southern Accents Lodging can be reserved in addition to wedding or daily rental of the venue, or as a stand-alone lodging reservation.

3 PM Check-in / 10 AM Check out for all lodging

Chapel Suites - sleeps 12

The Chapel Suites are adjoined to the historic mid-1900s chapel.

Includes 6 bedrooms, 2 full bathrooms, and access to the downstairs dining/lounge area, two half-baths, and kitchen equipped with sink, stove, double oven, refrigerator, and counter-top prep area.

Rate \$450.00/Night

Lodge House - sleeps 8

Includes 3 bedrooms, 1 full bathroom, living room, and kitchen equipped with refrigerator, stove/oven combo, microwave, and coffee pot.

Rate \$225.00/ Night

Please review important Event Rental Policies on pages 5, 6, & 7.

Rental Policies

Reservation Dates

Southern Accents Venue (SAV) is unavailable for reservation between November 1 – January 31. Reservations are not confirmed until deposit is received and contract is signed.

Deposit & Contract Requirements

A non-refundable and non-transferable deposit and signed contract are required to hold an event space.

Deposit amount is **40%** of your total reservation price.

After receiving your deposit, SAV owners will draw up a contract based on your selected date and venue reservation requests. The contract must be signed and returned within **2 weeks** in order to move forward with your reservation.

Your date is not confirmed until this deposit and signed contract is received.

Payment & Taxes

Remaining balance for your rental reservation is **due in full 30 days before** your event date. If remaining balance is not paid in full 30 days before your event date, the venue will become available for another event to be scheduled.

Arkansas state tax will be collected in addition to rental pricing.

Alcohol & Smoking Policy

Out of respect for the history of the Chapel, no alcohol or other food and beverages are allowed within the sanctuary area. Alcohol is allowed in all other venue areas.

SAV strictly adheres to and enforces all Arkansas state liquor laws and reserves the right to refuse any vendor not in accordance with these laws as well as the right to cancel any renter without notice or refund if found in violation of these laws.

No smoking in any indoor venue spaces, including lodging.

Set-Up and Clean Up

Set up and clean up time is included in your rental agreement. If you reserve a space for four hours,

Rental Policies Continued

then set up and clean up must happen within those four hours.

Before leaving the venue, renters are required to return the grounds to their original, clean condition. This includes removing all trash, catering, decor, floral supplies, or other items brought onto the property.

Cigarette butts must be disposed of properly, using provided receptacles, and not on the venue grounds.

Kitchen and lodging rooms must also be returned to pre-rental condition, including emptying and wiping refrigerators, cabinets, dishwashers, and cooking surfaces.

In the event that a venue space or lodging area is left unclean, the renter will be promptly charged a cleaning fee in an amount deemed appropriate by SAV owners.

Overuse of Property

The renter and their guests shall only use the spaces agreed to in the reservation contract. It is the renter's responsibility to ensure that guests only use these spaces. Any use of unreserved space will be invoiced promptly.

Damages

The renter agrees to maintain all event and lodging spaces in the same condition in which they were provided. The renter also assumes liability of any damage caused by the renter or guests due to negligence; this includes damage to interiors, exteriors, and supplies.

In the event of damage, guests should immediately notify SAV owners so that the situation can be properly managed. At no time should a guest attempt to repair damage on their own.

Any property or lodging damages will be assessed by SAV owners who will determine a price to fix the damage based on their self-repair estimation or a quote from a local repair company or person. Choice of repairman or company is entirely up to SAV owners.

Noise and Quiet Hours

Quiet hours are from midnight to 6 a.m., including on weekends. SAV owners reserve the right to cancel any renter without notice or refund if found in violation of the Noise and Quiet Hours policy.

Venue: No venue reservations will extend past midnight. If your reservation is until midnight,

Rental Policies Continued

all event noise and cleanup must be complete by 12:00 a.m.

Lodging: Overnight guests must adhere to the quiet hours policy by maintaining a reasonable level of noise in the lodging areas from midnight to 6 a.m.

Cancellation Policy

Cancellations received a minimum of 60 days or more prior to the event date will not receive return of deposit, but will receive return of any other rental payments.

Cancellations received within 60 days of the event date will not receive return of deposit and will not receive return of any other rental payments.

Preferred Vendors

We recommend these vendors based on their quality, offerings, and proximity to Southern Accents Venue.

Southern Charm Catering & Events

Southern-style, elegant catering for any special event, plus wedding planning and directing. Contact Cyndi Doepel at 870-734-7045.

A Perfect Bloom, Florals & Wedding Rentals

Offering full-service florals, wedding rentals, and delivery. Located in Beebe, AR. Contact Perfect Bloom at 501-882-2144 or learn more at perfectweddingrentals.com.

Cajun Express Catering

Contact Robin Gehring at 870-734-7118.